

TOWN OF CANTON Residential Property Card

Property at 00024 SWEETHEART MOUNTAIN ROAD 8 Account 5100024 Printed 25-Oct-2011 9:15 AM Design and Layout (C) Right/Angles

Administrative Information
 Owner name: ROHAN KAREN S &
 Second name: LYNCH KEVIN M
 Address: 24 SWEETHEART MOUNTAIN RD
 City/state: CANTON CT Zip: 06019

Building Valuation Summary

Dwelling	Frame	2 story w/bsmt	Area	1,472	254,530
Basement	Full with walk				
Heating	Yes	A/C	Yes		7,710
Plumbing	4 F/B	1 H/B	4 Add'l fix.	1 Wh/p	Saunas 17,700
Attic	None			Attic size:	
Additions					77,700
Other Features	WB Stks	Unfin	3,500	26,210	
Sub-Total					383,850
Grade	A-	Factor	1.4500	556,580	
CDU		C&D Factor	1.00	556,580	
Depreciation		%		556,580	
				Computed cost value @ 70%	389,610

Location Information		Last sale	
GIS: 510 0024	Clk Map: 02669	Sale date:	
Parcel: 5100024	Map: 6-2	Sale price:	
Neigh.: Zone: AR-1	Vol: 382	Sale valid:	
Assessments		Values	
Assmt category	Qty	Amount	
Resident Land	1.00	105,000	
Resident Dwelling	1.00	389,610	
Summary		Sales ratios	
Total assessments	494,610	Cost/sale :	
Total exemptions		Mkt/sale :	
Net assessment	494,610	Assmt/sale:	

Building additions

Category	Type	Area	Value
G Garages	FRL Attached frame GT 65	834	26,400
G Garages	FSF Full-story fin o/gar	528	25,000
L Living Area	AIR Air conditioning	528	1,100
L Living Area	FRFF Frame first floor	20	1,600
P Porches, Patios, Decks	DECK Wood deck	417	7,800
L Living Area	BSMT Basement addition	75	1,000
L Living Area	FRFF Frame first floor	75	6,100
L Living Area	AIR Air conditioning	75	200
P Porches, Patios, Decks	FOFF Frame open first flo	90	3,900
L Living Area	BSMT Basement addition	48	600
L Living Area	FRFF Frame first floor	48	3,900
L Living Area	AIR Air conditioning	48	100
Total additions			77,700

Land Information

Type	Use	Acres/SqFt	Rate	Total	Infl	Fact	Value	70% Value
PRIM	11	1,000	150,000				150,000	105,000
Primary Site		43,560						
1.0000 acres				Total land value			150,000	105,000

Residential Dwelling Information

Subject	Code	Description	Condominium	
Style	19	Modern Colonial		
Exterior Walls	01	Clapboards		
Roof Material	01	Asphalt Shingles	Story Height 2.0	
Roof Type	02	Hip		
Foundation	01	Poured Concrete	Total Rooms	9
Interior Walls	02	Drywall	Garage cars	3
Floors	07	Hardwood/Carpeti	Bedrooms	4
Heating System	02	Forced Hot Air	Unfinished area	
Fuel	07	Propane Gas	Family Rooms	1
Attic	99	None	Dormer linear f	
Grade	47	A-	Full Baths	4
Garage	23	Attached 3 car	Masonry trim sf	
Area Over Gar.	01	Fully Finished	Half Baths	1
Basement	04	Full with walk-o	Finish bsmt sz	
Bsmt Fin Qual	03	Rec Room W/ Air	Addtn'l fixtures	4
Air Condition	01	Central Air	Rec Room Size	1,200
Interior Cond	05	Good	Living area	3,615
Exterior Cond	05	Good	Whirlpools	1
			Saunas	
			# Living Units	1
			M/F stacks	
			W/B stacks	1
			W/B openings	1
Actual Year Built: 2008				

Property at 00024 SWEETHEART MOUNTAIN ROAD 8

Account 5100024

Printed 25-Oct-2011 9:15 AM Design and Layout (C) Right/Angles

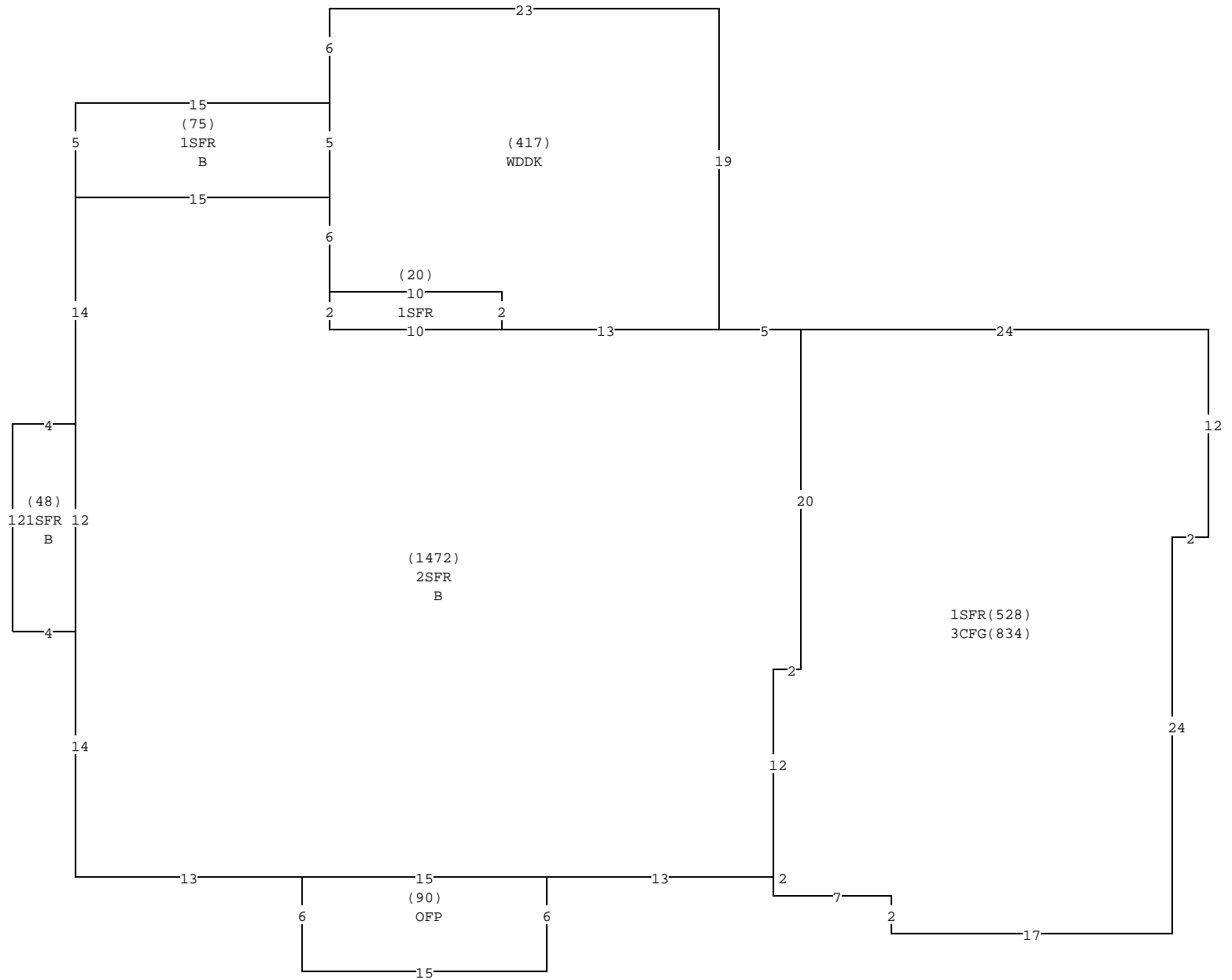

Notes: CORRECTING QC 382/1078